

MAX 6

2-in-1 Automatic Card Shuffler and Dealer



User Manual

Question or Concern?
support@wxkpaw.com

PRODUCT DESCRIPTIONS



Card Tray
USB-C Charging Port
Non-Slip Silicone
Touch Pause Area
Display
Card Dispenser



Adjustable Baffle
SHUFFLE
DIRECTIONAL DEAL
RANDOM/SPECIFIED DEAL
DEAL
PLUS/UP (+)
MINUS/DOWN (-)
Player Count
Cards Per Player
POWER/HOME
SETTING/NEXT
Extra/Community Cards

CONTROLS & DISPLAY

- POWER/HOME**
Press to turn on. Hold for 3 seconds to turn off. Press to return to the homepage while the machine is on. Auto-off after 30 minutes of inactivity.
- SETTING/NEXT**
Press to enter settings, press again to confirm and proceed to the next setting. Hold for 3 seconds to access [Advanced Settings].
- SHUFFLE**
Press to start shuffling. Press again to stop. Shuffling automatically stops in 2 seconds after all cards have been conveyed from the card trays.
- DEAL**
Press to start dealing.
- RANDOM/SPECIFIED DEAL**
Press to scroll through the [PLAYER] number. When scrolling stops, dealing starts from this randomly selected position. To set a specific position, hold until the [PLAYER] number flashes. Use and to select the desired position, then press or to confirm and start dealing.
- DIRECTIONAL DEAL**
In [Back-Forth Deal] mode for 3 players or [360° Rotate Deal] mode for 3 or 4 players, press the corresponding direction of to start dealing from that position.
- Touch Pause Area**
Touch this area to pause dealing. When paused, flashes. Press to resume dealing, or press to stop dealing and return to the homepage.
- Pause Indicator**
 remains lit when the machine is on for an extended period without interaction. During a pause, flashes. Press to stop flashing.
- Card Counting**
Hold to start counting, or set [PLAYER] to 0 and press to start counting.
- Single Card Draw**
Press or to draw a card.

USAGE INSTRUCTIONS

Press to navigate through each setting. The flashing value indicates this setting is adjustable. Use or to toggle options. Press or to exit and return to the homepage. Follow the sequence in the diagram below:

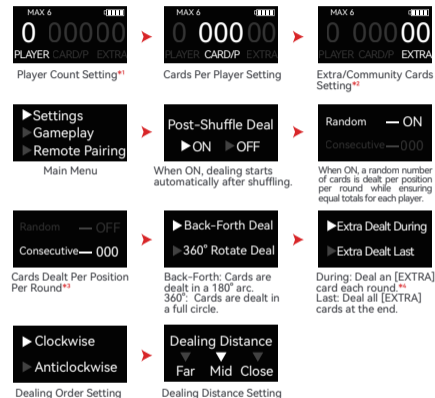

- * 1. [360° Rotate Deal] supports 1-12 players; [Back-Forth Deal] supports 1-8 players;
- * 2. [CARD/P] can be set from 1-999, and [EXTRA] from 1-99. The capacity of the card chamber is 2 decks; exceeding 2 decks requires multiple loads;
- * 3. When the number of [Consecutive] is set to ≥ 1 , [Random] is automatically OFF. When [Random] is ON, [Consecutive] is automatically set to "000";
- * 4. If [EXTRA] cards exceed the number of rounds under [EXTRA Dealt During], the excess is dealt at the end. For [PLAYER] ≥ 7 in [360° Rotate Deal], the machine pauses after dealing to all players. Press to deal remaining [EXTRA] cards.

GAMEPLAY SETTINGS

After accessing the main menu, select [Gameplay] to access the preset gameplay menu. Alternatively, press to directly access the gameplay menu from the homepage.



[Texas Hold'em]



Under selecting, press or to access [Texas].

Press to enable player count setting, and press or to set the number of players. Press to confirm.

Press to deal 2 hole cards to each position, then [Flop] will be displayed.



Press to deal 1 [Burn] card to the side of the machine, then deal 3 [Flop] cards. After dealing, [Turn] will be displayed.

Press to deal 1 [Burn] card to the side of the machine, then deal 1 [Turn] card. After dealing, [River] will be displayed.

Press to deal 1 [Burn] card to the side of the machine, then deal 1 [River] card. After dealing, [Texas] will be displayed.

[Bridge] Page

Select [Bridge (4/13/0)] to access the [Bridge (4/13/0)] page. Press to start dealing according to the preset [PLAYER 4, CARD/P 13, EXTRA 0].



REMOTE PAIRING

After accessing the main menu, select [Remote Pairing] to enter the remote pairing mode. The steps are as follows:

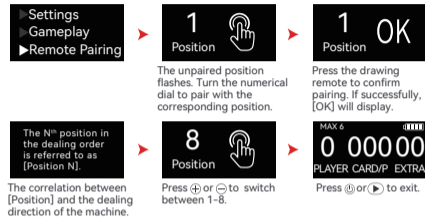

Usage Instructions for Drawing Remotes

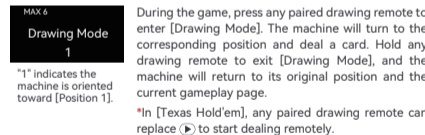

Advanced Settings

Hold ⊕ for 3 seconds to access the [Advanced Settings]. Default settings are recommended (as shown below):

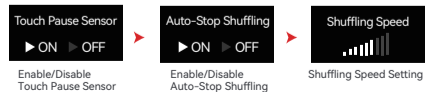

PACKAGE CONTENTS

- 1 × MAX 6 Automatic Card Shuffler & Dealer
- 4 × Wireless Drawing Remotes
- 1 × USB-C Charging Cable
- 1 × User Manual
- 1 × Packaging Box

SPECIFICATIONS

Product: 2-in-1 Automatic Card Shuffler & Dealer	
Dimensions: 6.4 × 5.0 × 4.6 in (16.2 × 12.7 × 11.6 cm)	
Model: MAX 6	Material: ABS/POM Plastic
Batteries: 5200mAh	Weight: 1.83 lb (830 g)
Input: USB-C 5V 2A	Display: OLED

CARE & MAINTENANCE

- Before using this machine, please read the user manual thoroughly and use it according to the instructions.
- Keep the card conveyor wheels clean to ensure smooth shuffling.
- Do not use or store the machine with temperatures exceeding 131°F (55°C) or in direct sunlight. Do not put it in fire or water.
- Do not disassemble the machine as it does not contain self-serviceable parts.
- Ensure cards are not warped or deformed and surfaces are clean, as this can affect proper shuffling.
- Avoid strong vibrations, impacts, or shocks to the machine, as these can interfere with proper shuffling.
- To ensure battery longevity and safety, avoid complete discharge and recharge the machine when the battery level is low.

TROUBLESHOOTING

Problem	Possible Solution
The machine does not respond.	Ensure the machine has sufficient battery power.
	Ensure the machine is not charging.
Shuffling does not automatically stop.	Turn off [Auto-Stop Shuffling] if certain cards aren't detected due to their unique material.
Cards are jammed during dealing.	Ensure that the cards are flat and not bent.
Cards are dealt to incorrect positions.	Make sure the machine is placed on a flat and stable surface.
	Check the machine's base for debris.
The machine inconsistently deals too many or too few cards.	Check if [Random] mode is ON, which may cause variation in dealt cards per round.
	Adjust the card outlet or check for any mechanical obstructions.
The machine deals cards in random directions.	Clean the sensor in the card dispenser to remove dust or debris that could be causing sensitivity issues.
	If the problem remains, contact customer support for further help.
The machine is dealing multiple cards at once.	Check if the cards are bent or damaged.
The machine pauses unexpectedly during dealing.	Turn off [Touch Pause Sensor] if the sensor is overly sensitive, especially in extreme cold or unusual environments.

The machine is rotating 360° without dealing cards.	Restart the machine.
	Clean the sensor in the card dispenser to ensure proper function.
Number of cards dealt is incorrect after pausing and resuming.	If paused for more than 30 minutes, restart the machine before resuming.
	Ensure that the dealing function is resumed correctly.
The drawing remotes do not respond.	Refer to the Remote Pairing section in the manual, ensure that the machine is in pairing mode and the remotes are properly synchronized.

If your problem is not listed or solved, please contact our Customer Support Team.

WARRANTY

Thank you for your purchase. Your satisfaction is our top priority. We stand behind our products with a comprehensive 2-year warranty.

Coverage: We replace machines with manufacturing defects, faulty materials, or craftsmanship issues. during the warranty period.

Exclusions: Damages from misuse, abuse, unauthorized modifications, fair wear and tear, or external events (e.g., accidents, natural disasters).

Claim Process: Email support@wxkpaw.com with your order ID or receipt. Describe the issue and attach relevant pictures or documentation.

Need Help? Contact Our Customer Support Team

support@wxkpaw.com

For any questions or concerns regarding your new product, feel free to contact our **Customer Support Team**.

Email: support@wxkpaw.com

Manufacturer: Weixing Chuangke (Shenzhen) Technology Co., Ltd

Inquiries: info@wxkpaw.com

Address: 956-958 Jiaxiye Plaza, No. 318 Minzhi Avenue, Minzhi Community, Minzhi Street, Longhua District, Shenzhen, Guangdong, China

Made in China

Please read the manual carefully before use and keep it for future reference.